

Cup Properties

Maximum Fill Volume	56.2 oz / 1662 ml
Practical Volume	56.0 oz / 1656 ml
Stack Height	28.3" / 50 Cups
Sidewall Material 20 PT, Polycoated 2 Sides - 3/4 X 1/2 mm	
Bottom Material 17.4 PT, Polycoated 2 Sides - 3/4 X 1/2 mm	

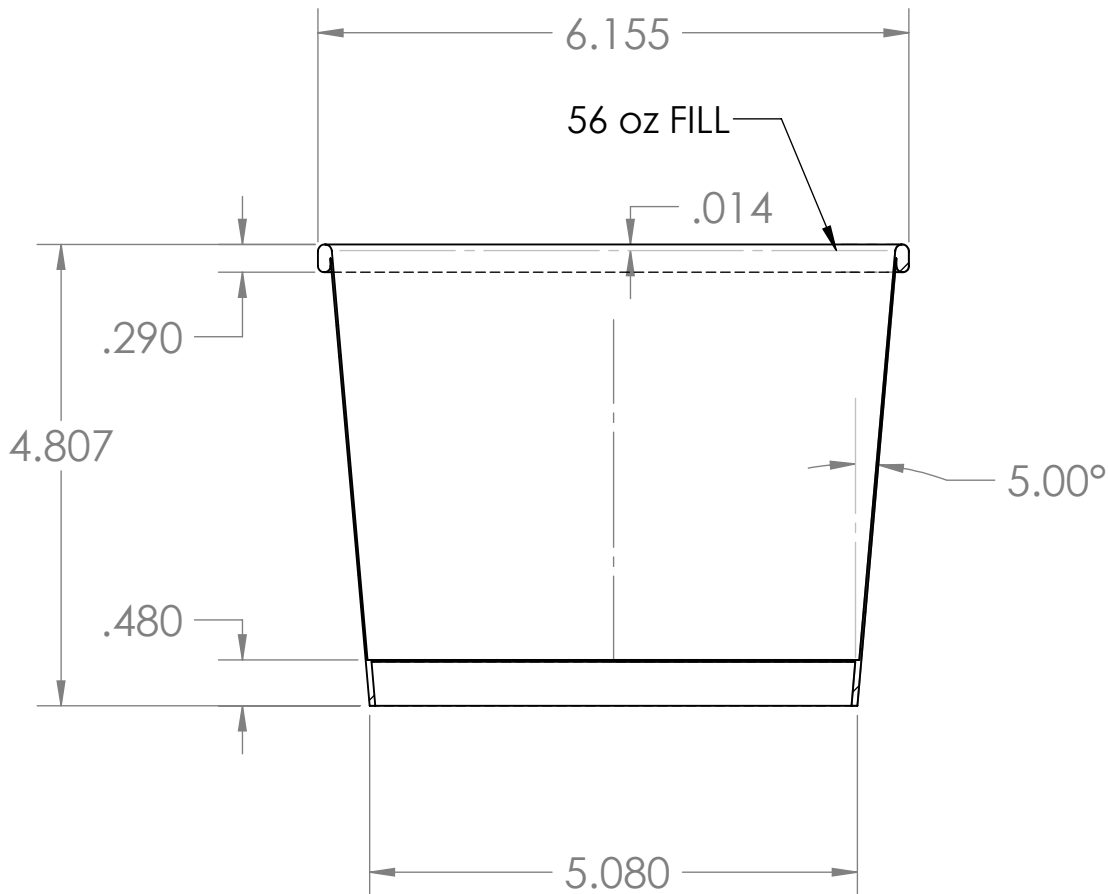

PROPRIETARY AND CONFIDENTIAL		 www.stanpacnet.com	SIZE	REV
The information contained in this drawing is the sole property of Stanpac Inc. Any reproduction in part or as a whole without the express written consent of Stanpac Inc is strictly prohibited.			A	*
UNLESS OTHERWISE SPECIFIED: All Dimensions in Inches Tolerances as follows: Fractional ±1/16" Decimal X.X" ±0.02" X.XX" ±0.01" X.XXX" ±0.005" Angular Dimensions ± 0.5°	DATE: 7/31/2009 DRAWN BY: Jon Heida USED ON: -----	DWG #: 10560100 MATERIAL: ----- TITLE: 56 oz / 1.65 L, Round Cup	SCALE: 1:2	SHEET 1 OF 1

Lid Properties

Disc Material 16 PT, Polycoated 1 Side 3/4 mm

Tube Material 15 PT, Uncoated

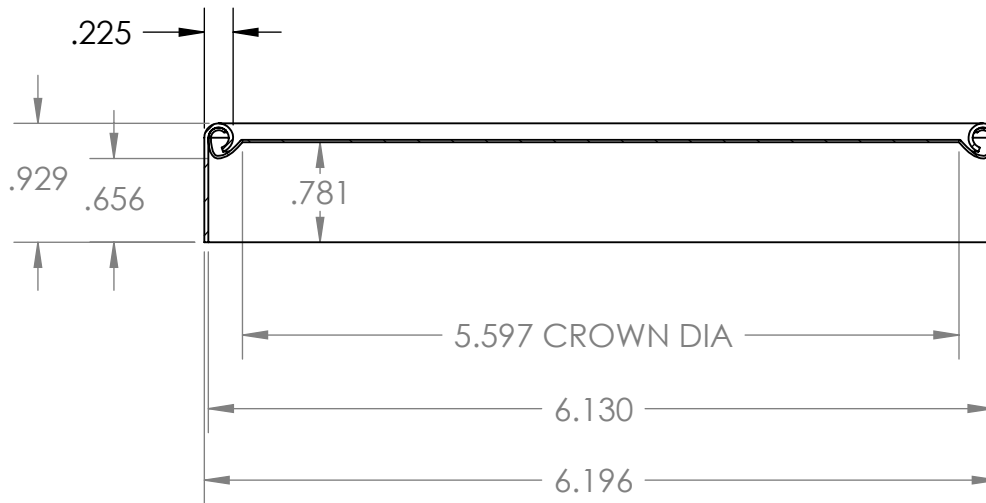
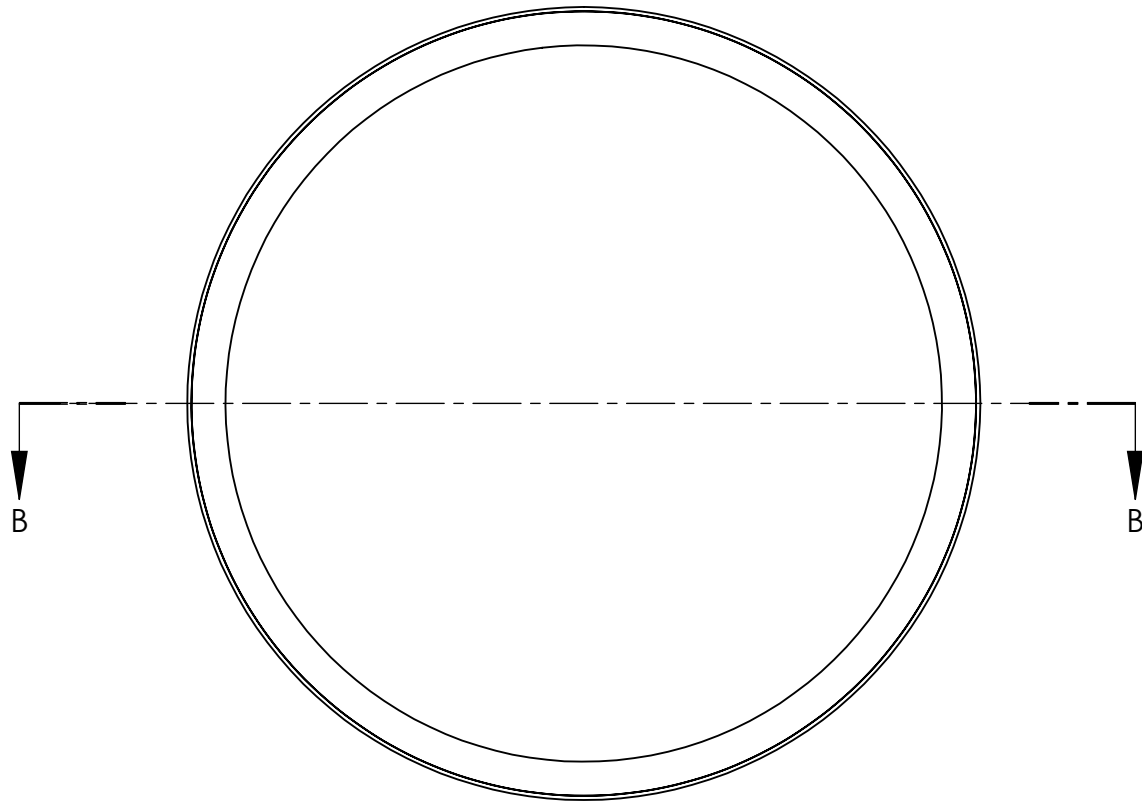

SECTION B-B

PROPRIETARY AND CONFIDENTIAL

The information contained in this drawing is the sole property of Stanpac Inc. Any reproduction in part or as a whole without the express written consent of Stanpac Inc is strictly prohibited.

UNLESS OTHERWISE SPECIFIED:

All Dimensions in Inches
 Tolerances as follows:
 Fractional $\pm 1/16$ "
 Decimal X.X" ± 0.02 "
 X.XX" ± 0.01 "
 X.XXX" ± 0.005 "
 Angular Dimensions $\pm 0.5^\circ$

DATE: 7/31/2009

DRAWN BY:
Jon Heida

USED ON:

DWG #:

20560100

MATERIAL:

TITLE:

56 oz Spiral Wound Lid



www.stanpacnet.com

SIZE

A

REV

*

SCALE: 1:1.5

SHEET 1 OF 1